

TIGARD CENTRAL INDUSTRIAL PARK

12670 - 12700 SW Hall Boulevard | Tigard, OR 97223

FOR LEASE

AGGRESSIVE RATE



1 MONTH FREE PER YEAR OF LEASE WITH QUALIFIED TENANTS

INDUSTRIAL SPACE AVAILABLE FOR LEASE

DETAILS

- Suite G: ± 30,815 SF **NEW TO MARKET!**
 - Two (2) huge oversized grade level door (20' wide x 20' high)
 - Dock inside space including drive-up ramp
 - 480v, 3-phase power (large amps available)
 - 24' clearance height
 - Drive-thru entire length of building with indoor parking
 - Excellent opportunity for landscaper, roofer, construction company, plumber, etc.
- Lease Rate: \$0.50 PSF + NNN
- Estimated NNN: \$0.14 PSF

FEATURES

- Located on SW Hall Blvd, 3 minutes to Hwy 99W, Hwy 217, and I-5
- Close to Tigard Transit Center, WES commuter rail
- Metal buildings offering a wide variety of uses

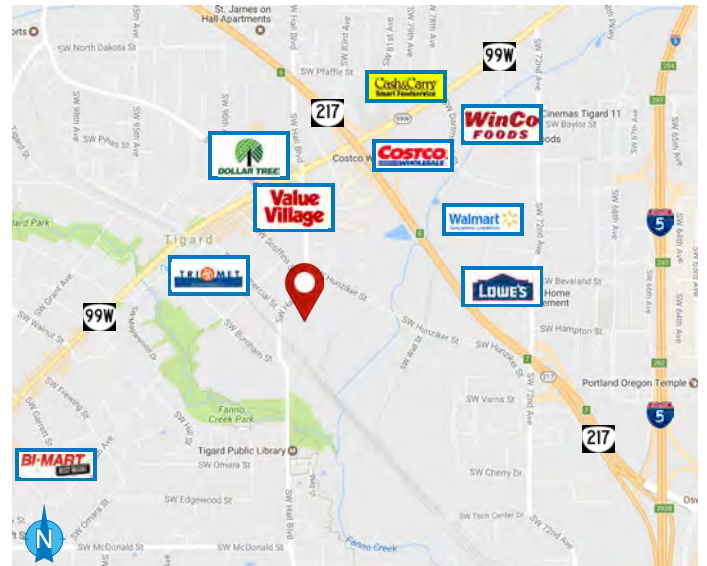

06.16.2026

For more information or a property tour, please contact:

SCOTT FINNEY, SIOR
503.225.8431
ScottF@norris-stevens.com

GREG NESTING
503.225.8440
GregN@norris-stevens.com

Norris & Stevens

INVESTMENT REAL ESTATE SERVICES

TCN
WORLDWIDE
REAL ESTATE SERVICES



Information contained herein has been obtained from others and considered to be reliable; however, a prospective purchaser or lessee is expected to verify all information to their own satisfaction.

900 SW 5th Avenue • 17th Floor • Portland, OR 97204
503.223.3171 • norris-stevens.com

TIGARD CENTRAL INDUSTRIAL PARK

12670 - 12700 SW Hall Boulevard | Tigard, OR 97223

FOR LEASE

FLOOR PLAN



For more information or a property tour, please contact:

SCOTT FINNEY, SIOR
503.225.8431
ScottF@norris-stevens.com

GREG NESTING
503.225.8440
GregN@norris-stevens.com

Norris & Stevens

INVESTMENT REAL ESTATE SERVICES



Information contained herein has been obtained from others and considered to be reliable; however, a prospective purchaser or lessee is expected to verify all information to their own satisfaction.

900 SW 5th Avenue • 17th Floor • Portland, OR 97204
503.223.3171 • norris-stevens.com