

BOONES FERRY PROFESSIONAL CENTER

15962 SW Boones Ferry Road | Lake Oswego, OR 97035

FOR LEASE



OFFICE SPACE AVAILABLE FOR LEASE

DETAILS

Suite 204: ± 1,658 RSF - \$27.75/RSF, MG

- Configured as a Healthcare Clinic or office suite, including: 5 treatment rooms or private offices, reception area, break area, work/lab areas, & private restroom.

Suite 208: ± 1,586 RSF - \$27.75/RSF, MG

- Presently configured as former Dental or Healthcare Clinic, including: reception room, break room, file area, private office, dark room, lab/work area, private restroom, & 4 treatment areas.

Can easily be converted to a general open office concept as shown.

FEATURES

- Building is elevator served
- On-site parking
- Prime Lake Oswego / Lake Grove location
- Easy access to I-5, Kruse Way, and Hwy 217
- Along Boones Ferry Retail Corridor and close to Bridgeport Village

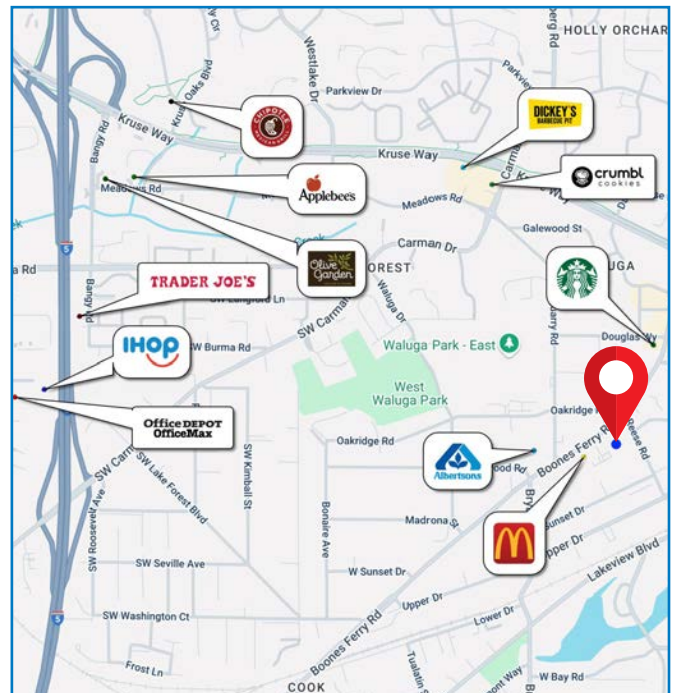

05.12.2025

For more information or a property tour, please contact:

CHARLIE DIGREGORIO

503.225.8468

CharlieD@norris-stevens.com

TIM PFEIFFER

503.225.8455

TimP@norris-stevens.com

Norris & Stevens

INVESTMENT REAL ESTATE SERVICES

900 SW 5th Avenue • 17th Floor • Portland, OR 97204
503.223.3171 • norris-stevens.com



Information contained herein has been obtained from others and considered to be reliable; however, a prospective purchaser or lessee is expected to verify all information to their own satisfaction.

BOONES FERRY PROFESSIONAL CENTER

15962 SW Boones Ferry Road | Lake Oswego, OR 97035

FOR LEASE

FLOOR PLANS

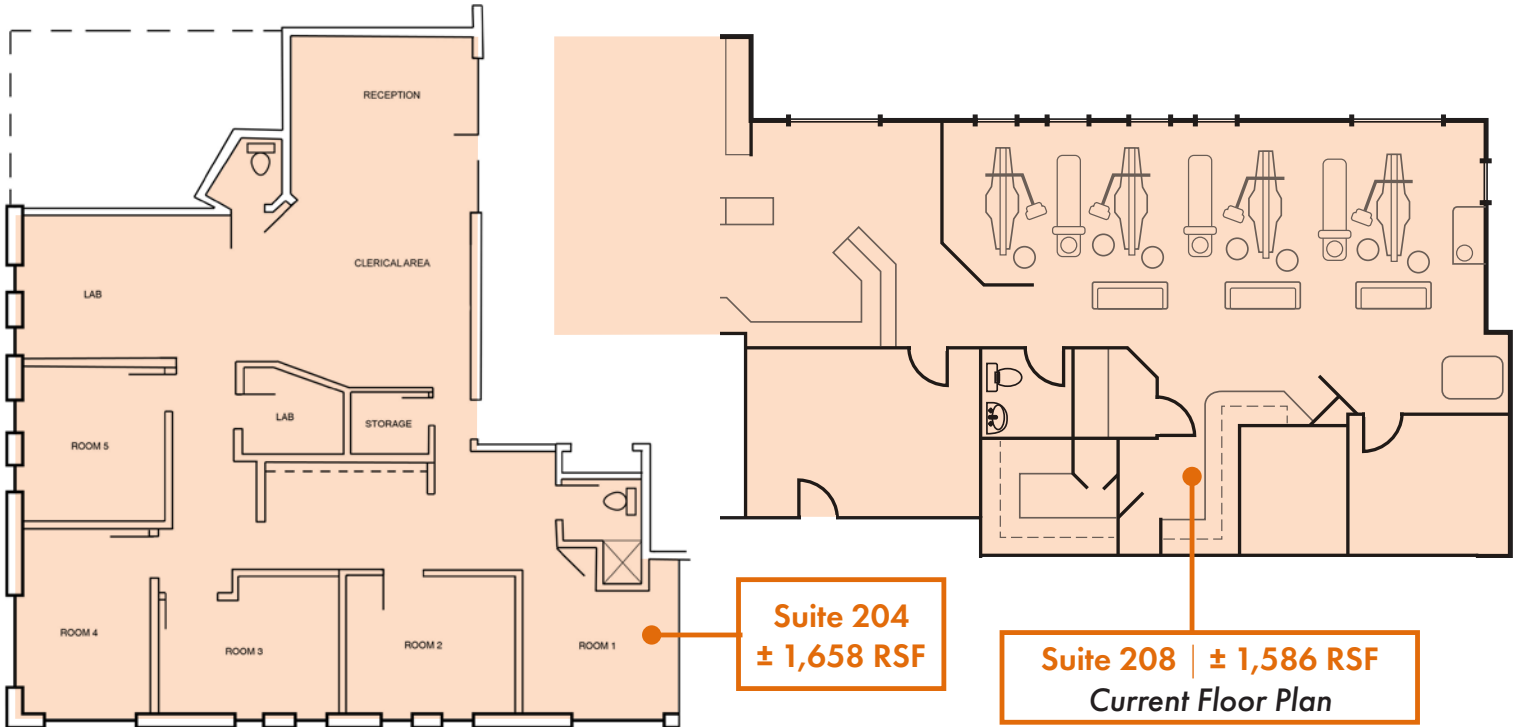

For more information or a property tour, please contact:

CHARLIE DIGREGORIO
503.225.8468
CharlieD@norris-stevens.com

TIM PFEIFFER
503.225.8455
TimP@norris-stevens.com

Norris & Stevens

INVESTMENT REAL ESTATE SERVICES



Information contained herein has been obtained from others and considered to be reliable; however, a prospective purchaser or lessee is expected to verify all information to their own satisfaction.

900 SW 5th Avenue • 17th Floor • Portland, OR 97204
503.223.3171 • norris-stevens.com