

270 WARNER MILNE RD

Oregon City, OR 97045

FOR LEASE



RETAIL/OFFICE SPACE FOR LEASE

DETAILS

- Available space: Suite B \pm 2,365 SF
Suite C \pm 3,346 SF
Available July 2024
- Lease rate: \$27.00 PSF, full service gross

FEATURES

- Built in 1972 / Recently renovated
- Zoning: MUE (Mixed-Use Employment)
- Parking: \pm 42 spaces
- Parking ratio: 4.5/1,000
- Professional retail/office
- Ample parking

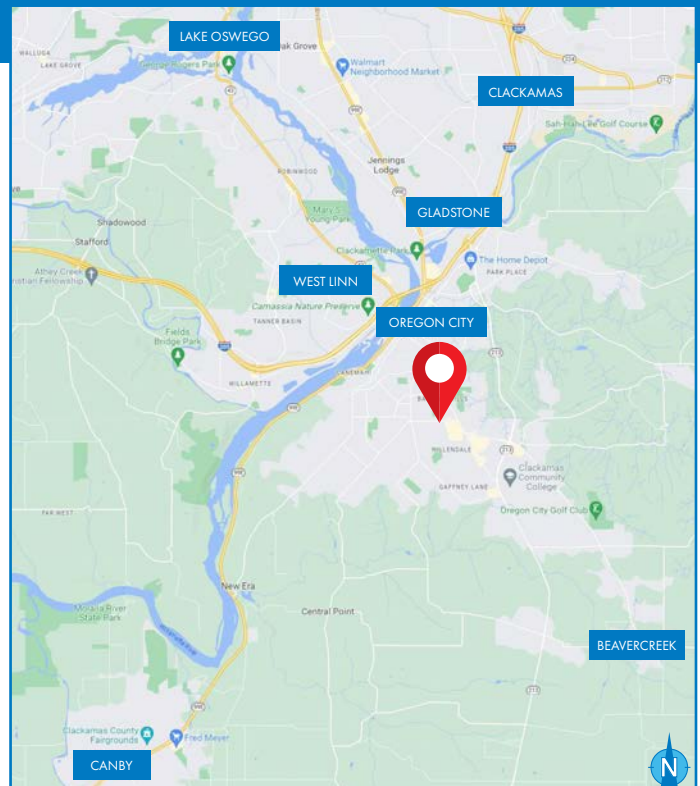

02.15.2024

For more information or a property tour, please contact:

TIM PFEIFFER

503.225.8455

TimP@norris-stevens.com

Norris & Stevens

INVESTMENT REAL ESTATE SERVICES

900 SW 5th Avenue • 17th Floor • Portland, OR 97204
503.223.3171 • norris-stevens.com



Information contained herein has been obtained from others and considered to be reliable; however, a prospective purchaser or lessee is expected to verify all information to his/her own satisfaction.

270 WARNER MILNE RD

Oregon City, OR 97045

FOR LEASE

FLOOR PLANS + PHOTOS

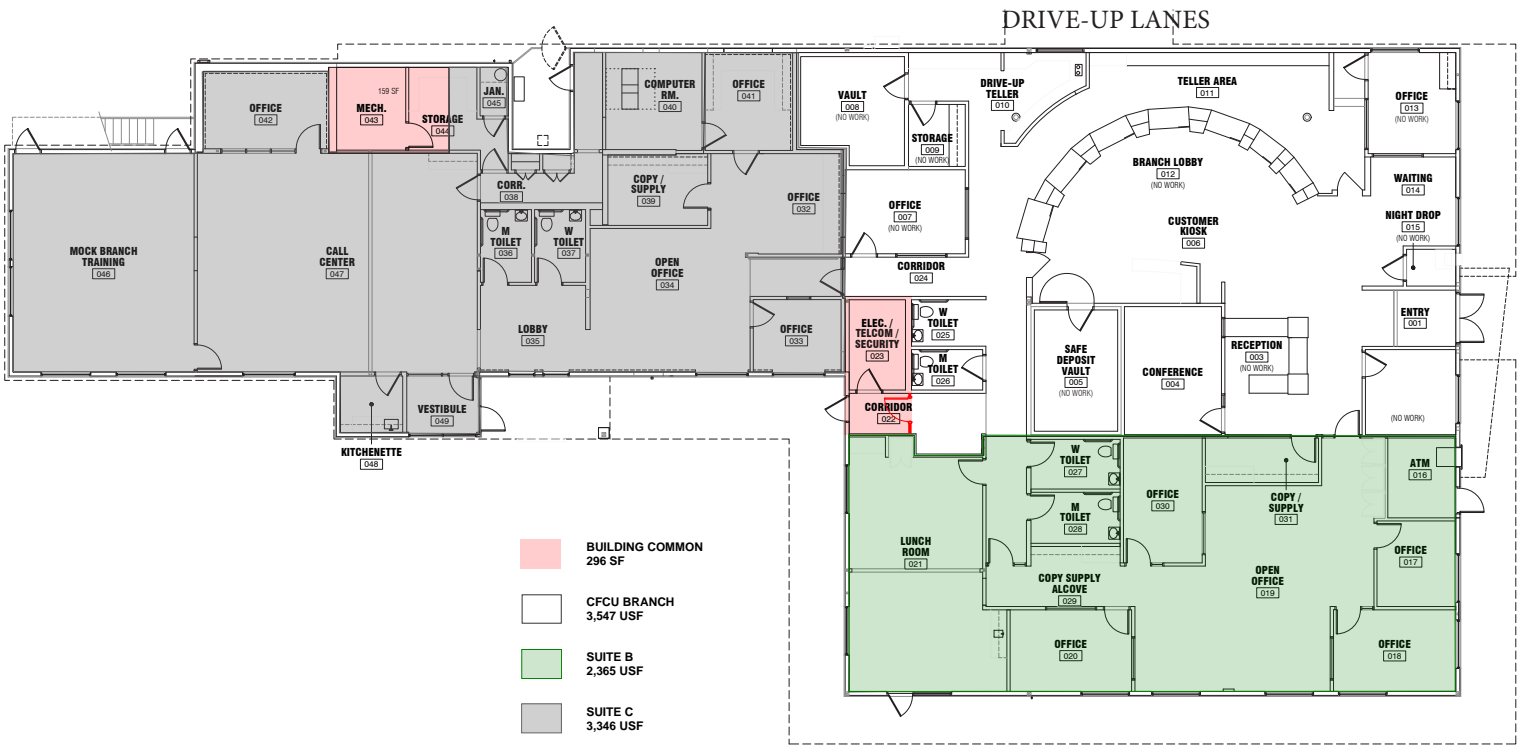

For more information or a property tour, please contact:

TIM PFEIFFER
 503.225.8455
 TimP@norris-stevens.com

Norris & Stevens

INVESTMENT REAL ESTATE SERVICES



Information contained herein has been obtained from others and considered to be reliable; however, a prospective purchaser or lessee is expected to verify all information to his/her own satisfaction.

900 SW 5th Avenue • 17th Floor • Portland, OR 97204
 503.223.3171 • norris-stevens.com

270 WARNER MILNE RD

Oregon City, OR 97045

FOR LEASE

RETAIL MAP

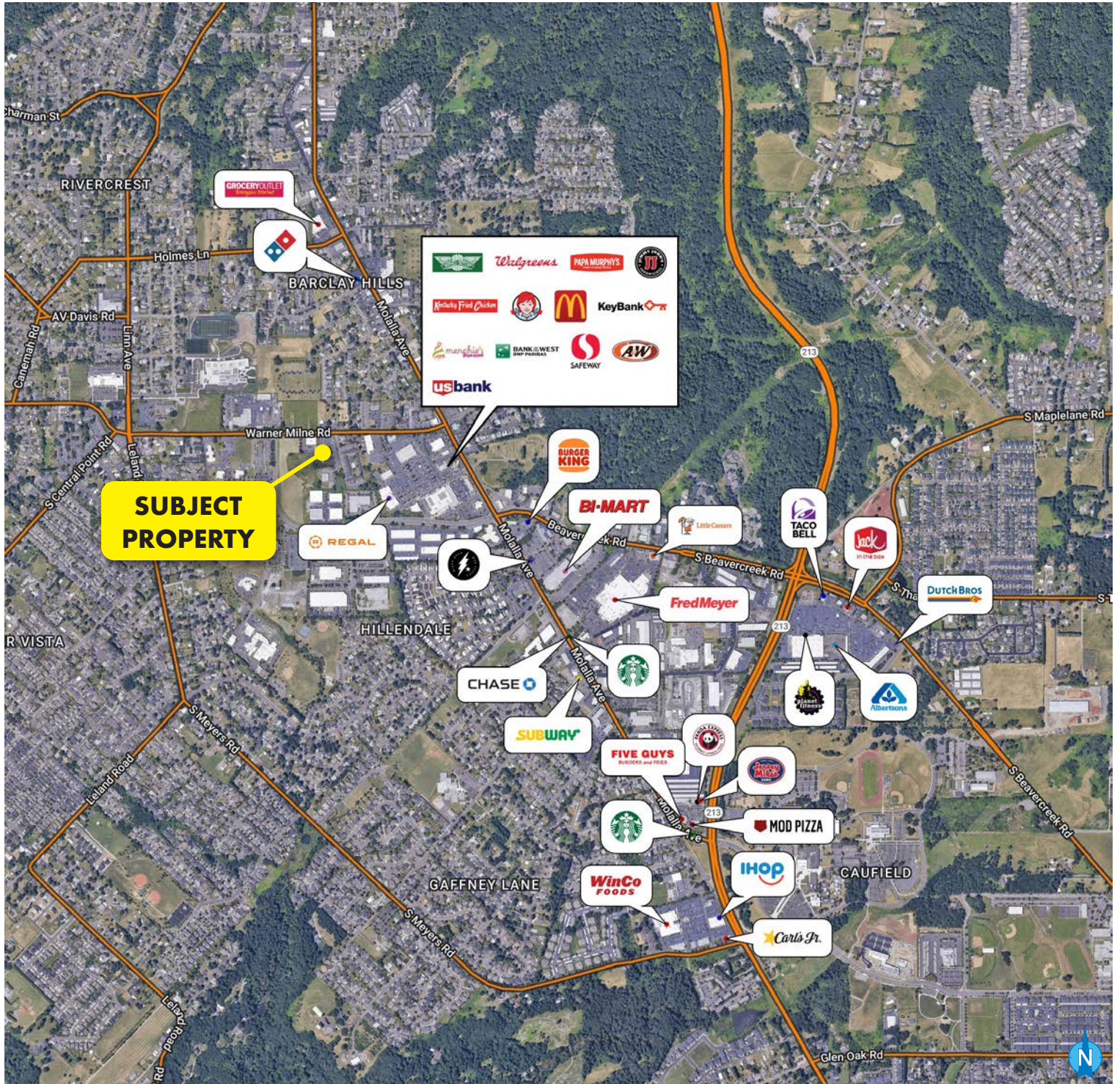

For more information or a property tour, please contact:

TIM PFEIFFER

503.225.8455

TimP@norris-stevens.com

Norris & Stevens

INVESTMENT REAL ESTATE SERVICES



Information contained herein has been obtained from others and considered to be reliable; however, a prospective purchaser or lessee is expected to verify all information to his/her own satisfaction.

900 SW 5th Avenue • 17th Floor • Portland, OR 97204
503.223.3171 • norris-stevens.com