

MISTY PLAZA

13327 SE Misty Drive | Happy Valley, OR 97086

FOR LEASE



OFFICE/RETAIL SPACE FOR LEASE

DETAILS

- Lower Level Retail Suites: ± 1,000 - 1,094 SF
Rate: \$34 PSF, NNN
- Upper Level Office Suites: ± 450 - 3,175 SF
Rate: \$34 PSF, FS

FEATURES

- Great visibility from Sunnyside
- Beautiful - New - First generation space
- Ideal for office or retail
- Easy access to I-205



06.16.2021

For more information or a property tour, please contact:

TIM PFEIFFER
503.225.8455
TimP@norris-stevens.com



Information contained herein has been obtained from others and considered to be reliable; however, a prospective purchaser or lessee is expected to verify all information to his/her own satisfaction.

Norris & Stevens

INVESTMENT REAL ESTATE SERVICES

900 SW 5th Avenue • 17th Floor • Portland, OR 97204
503.223.3171 • norris-stevens.com

MISTY PLAZA

13327 SE Misty Drive | Happy Valley, OR 97086

FOR LEASE

PROPERTY PHOTOS & FLOOR PLANS



FIRST FLOOR (RETAIL)

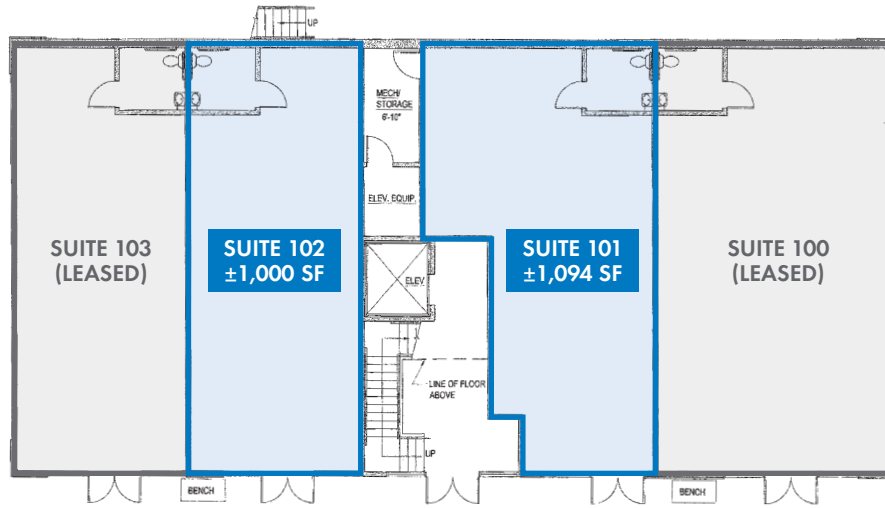

SECOND FLOOR (OFFICE)

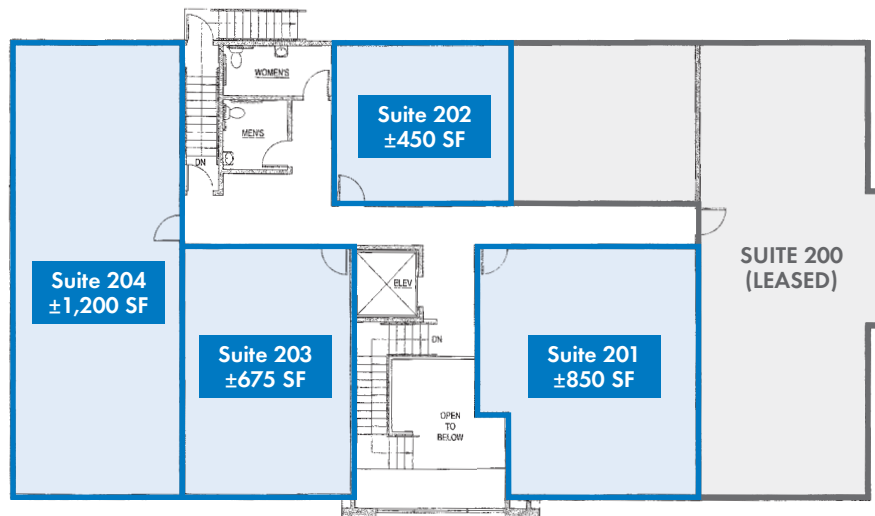

For more information or a property tour, please contact:

TIM PFEIFFER
503.225.8455
TimP@norris-stevens.com

Norris & Stevens

INVESTMENT REAL ESTATE SERVICES



Information contained herein has been obtained from others and considered to be reliable; however, a prospective purchaser or lessee is expected to verify all information to his/her own satisfaction.

900 SW 5th Avenue • 17th Floor • Portland, OR 97204
503.223.3171 • norris-stevens.com